

ALLDAY
& MILLER



Wilmar Close, Hayes, UB4 8ET
£650,000

 4  2  2  D



Wilmar Close, Hayes, UB4 8ET

£650,000

- Good Condition Throughout
- Semi Detached
- Garage
- Potential To Extend (STPP)
- Outhouse To The Rear Of Garden
- Chain Free
- 100+ ft Rear Garden
- Loft Room
- Four To Five Bedroom
- Viewings Advised!

Description

This home boasts four generously-sized bedrooms, with the potential to create a fifth bedroom in the loft if needed which has already been fitted. The property comes to the market with no upper chain, so there is no need to wait for the current to find a property.

The rooms are flooded with natural light and offer ample space for relaxation and personalisation. An impressive extension has been added to the house, providing extra living space, which can be easily converted into a home office, or a playroom, depending on your family's needs. The property has also been extended behind the garage to create a large kitchen.

This semi-detached home offers privacy and a sense of space, with the added advantage of sharing a wall with only one neighbouring property. The kitchen is a chef's dream, featuring modern fixtures and high-quality appliances. It's the heart of the home, perfect for family meals and entertaining.

The ground floor offers spacious living areas, including a bright and inviting living room and a dining area that flows seamlessly from the kitchen, creating an open and versatile space. Ample storage throughout the property including a garage, ensures your belongings are organised and out of sight. This house is ideal for families, with its multiple bedrooms, extended living spaces, and proximity to amenities and great schools.

Step outside to a beautifully landscaped garden that provides a peaceful retreat for outdoor activities, gardening, or simply enjoying the fresh air. At the bottom of the garden is a wonderful outhouse / log cabin which is perfect for a home office or gym.

Situation

Wilmar Close is situated in North Hayes and is walking distance to the Uxbridge Road providing an array of amenities, along with a choice of bus routes to Heathrow and the Elizabeth Line. Uxbridge road has a range transport links and shopping facilities are all close by. You are a short drive to Uxbridge and Hayes/Southall locations and have easy access to the A40/A312 dual carriageways. The newly opened Elizabeth Line is also easily accessible making journeys into central London a breeze. Metropolitan/Piccadilly Line trains run from Uxbridge Station.



Floor Plans

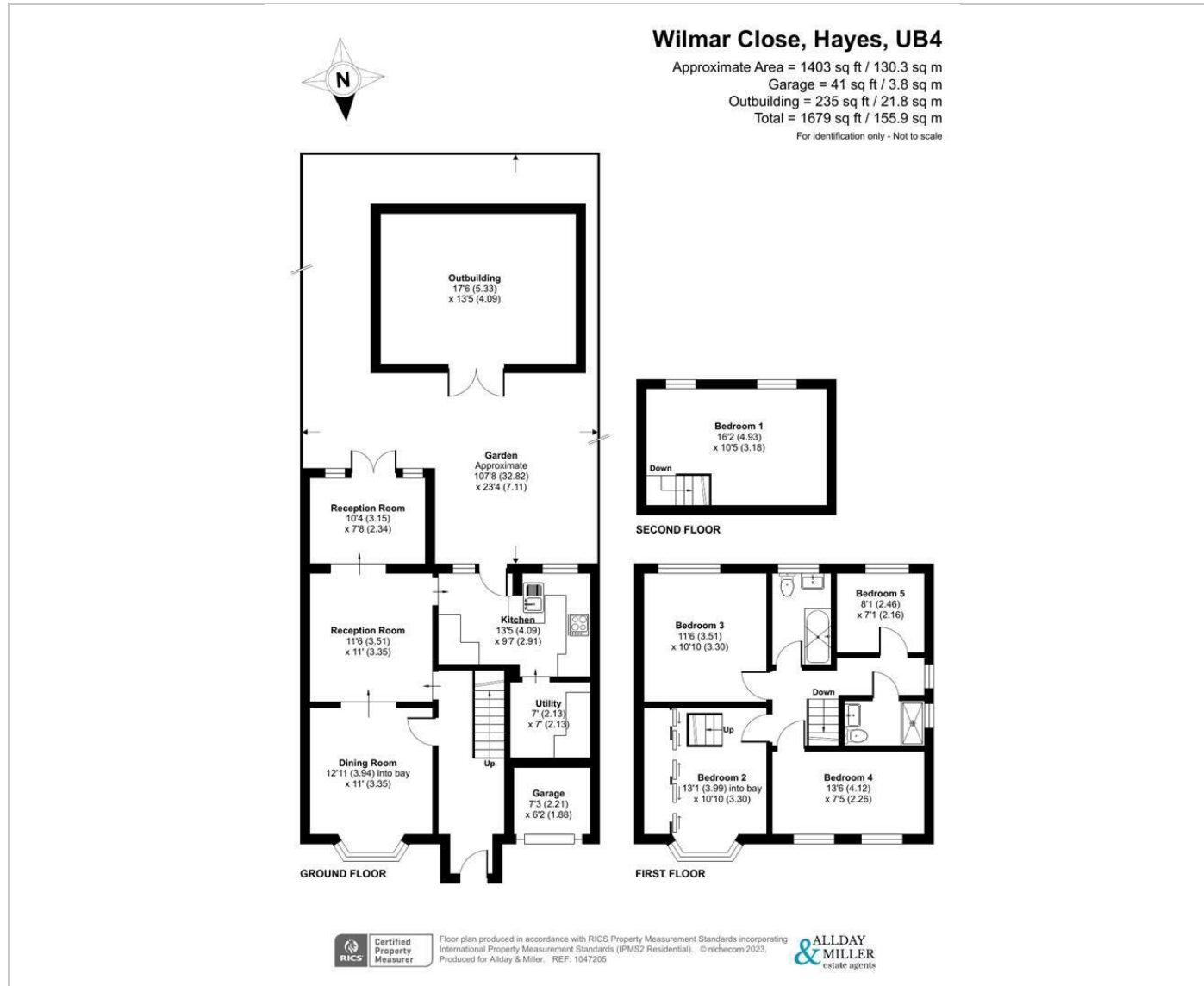

Area Map



Energy Performance Graph

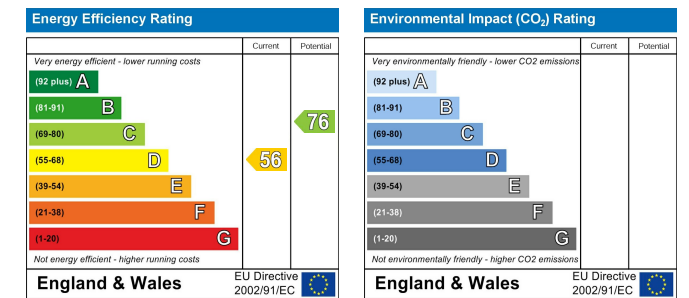

These particulars, whilst believed to be accurate are set out as a general outline only for guidance and do not constitute any part of an offer or contract. Intending purchasers should not rely on them as statements of representation of fact, but must satisfy themselves by inspection or otherwise as to their accuracy. No person in this firm's employment has the authority to make or give any representation or warranty in respect of the property.